

# ORV200 series

Hydraulic Refuse  
Compactors



**ORAKCI**  
Makina İmalat İth. İhr. San. ve Tic. A.Ş.





# 1. Equipment Dimensions

	Letter Code	5m <sup>3</sup>	6m <sup>3</sup>	7m <sup>3</sup>	8m <sup>3</sup>	9m <sup>3</sup>	10m <sup>3</sup>
Rear Overhang	*C			1885			
Truck Ground Clearance	*CH			700			
Total Length	D1	4241	4581	4921	5261	5601	5941
Body Height	*E	2658	2658	2658	2658	2658	2658
Body Internal Height	H			1500			
Useful Chassis Length	*Ca	1810	2150	2490	2830	3170	3510
Truck Chassis Width	CW			May Differ by Truck			
Body Length	G	2606	2946	3286	3626	3966	4306
Hopper Length	K			1346			
Loading Height	*I			951			
Tank Height	*M			1410			
Body Internal Width	J1			1962			
Body External Width	J2			2156			
Tailgate Hopper Internal Width	J3			1790			
Tailgate External Width	J4			2214			
Chassis Back Length	P			900			
Equipment Weight (kg) +3%	*	3330	3620	3710	3800	3890	3935

Parts marked with (\*) may differ by truck. The final dimensions become clear after the draft work. The table is for information purposes.  
 (\*) These are the base equipment data, they do not include optional equipment or accessories.  
 The equipment dimensions may vary by ±3% depending on the general tolerances.

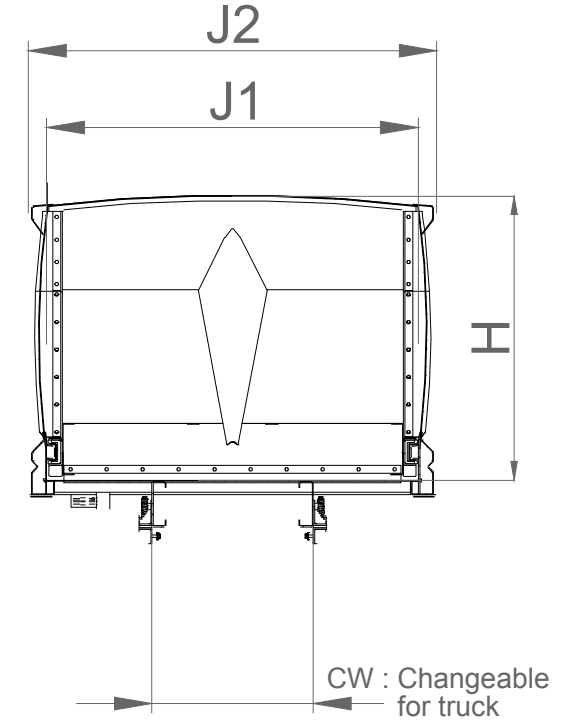
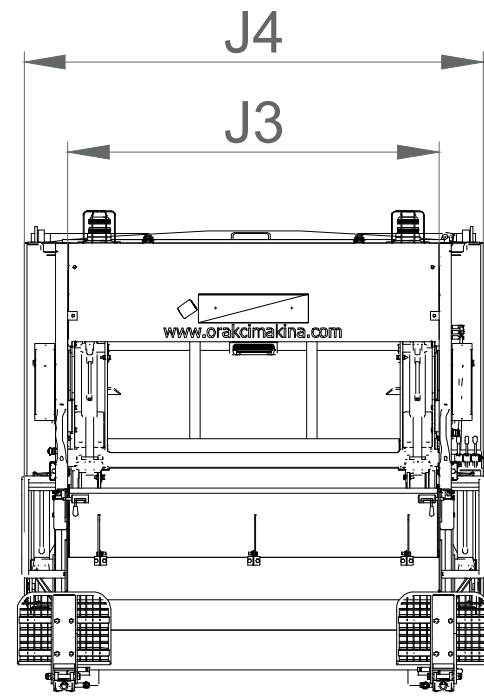
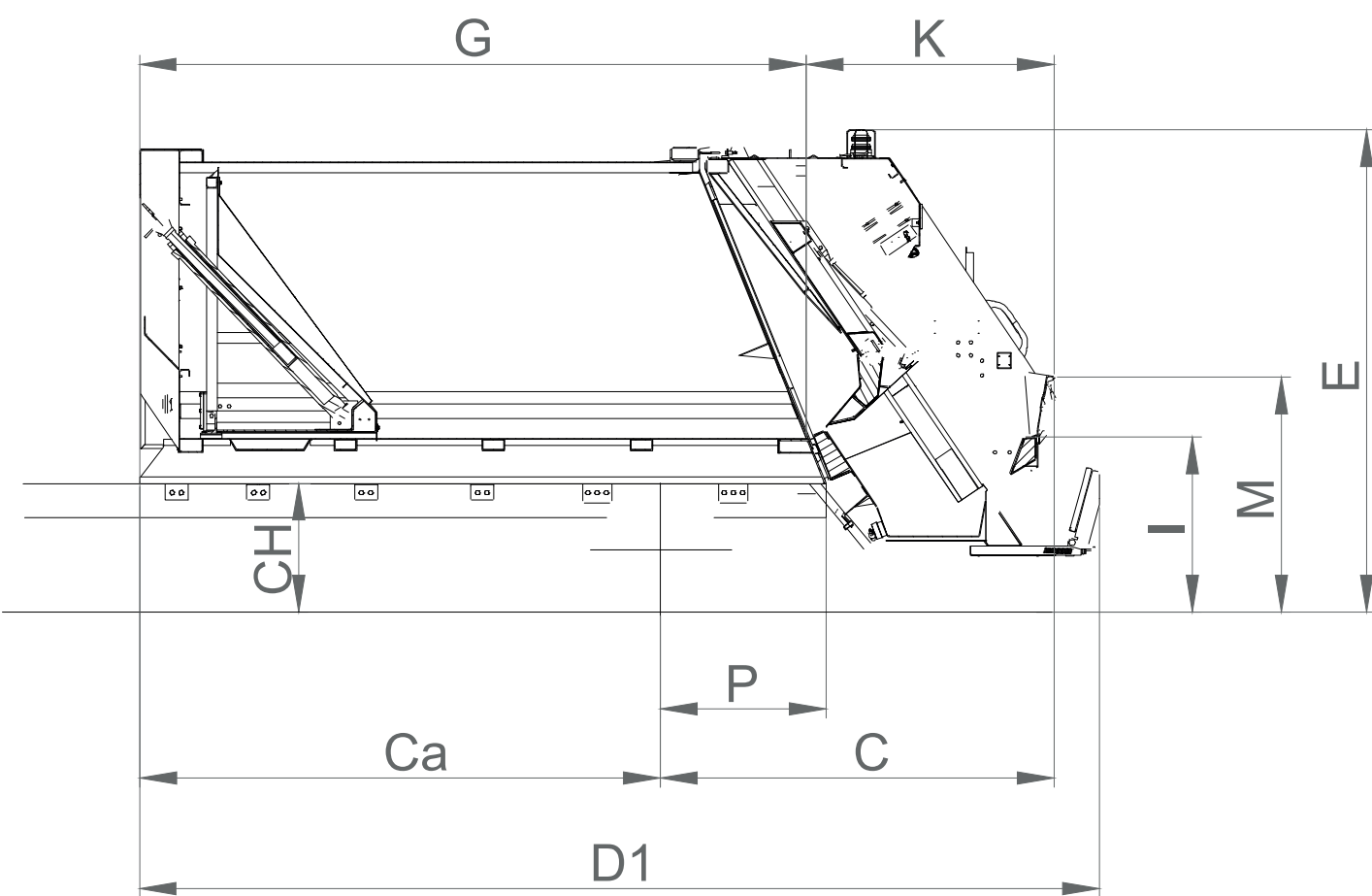

# 2. Body Capacity

Capacity	5 m <sup>3</sup> - 10 m <sup>3</sup>	
Working Hours	Waste Loading Duration	Waste Pressing Time
	8-10 secs	7-9 secs



# 3. Tailgate

Capacity		2 Series
	Without Hopper Extension	0.75 m <sup>3</sup>
	With Hopper Extension (opt.)	1.25 m <sup>3</sup>

Hopper Extension			
	Manual	Semi-Automatic	Automatic
With Bin Lifter	Optional	Standard	Standard
Without Bin Lifter	Optional	Optional	Standard



## 4. Waste Water Tank Capacity

Body		Tailgate	
Tank	44 lt.	Tank (Optional)	90 lt.
Additional Tank (Optional)	80 lt.		



## 5. Materials Used

Material	Body Bottom	Body Top	Blade Bottom Sheet
	S355J2C+N	S355J2C+N	Hardox 450
	Hardox 450 (Optional)	Hardox 450 (Optional)	
	Tailgate Hopper	Tailgate Side Wall	Slide Bottom Sheet
	Hardox 450	S355J2C+N	S355J2C+N
Hardox 450 (partial)		Hardox 450 (opt.)	

We offer Hardox 450 as an option for extending the useful life of the equipment located in the parts exposed to corrosion.



## 6. Hydraulic Features

ORV Hydraulic Features		
Pump	Pump Types	Gear Pump
		Piston Pump (Optional)
		Vane Pump (Optional)
		Tandem Pump (Optional)
	Operating Pressure	180 bar
2 Series		
Pump Flow Rate	55 lt. / min.	
	* Pump values may differ depending on motor output speed. Motor output speed Max. 1000rpm	
Oil Tank	2 Series	
	Capacity	120 lt.
	Suction Filter	125 µc
	Return Filter	25 µc



## 7. Bin Lifter Systems

Bin Lifter (Optional)	
	<ul style="list-style-type: none"> <li>• 120 lt - 1100 lt (EN 840)</li> <li>• 400lt - 800lt (TR)</li> </ul>

We produce systems whose EN 840 standard-compliant bin lifter is suitable for lifting plastic and metal containers.

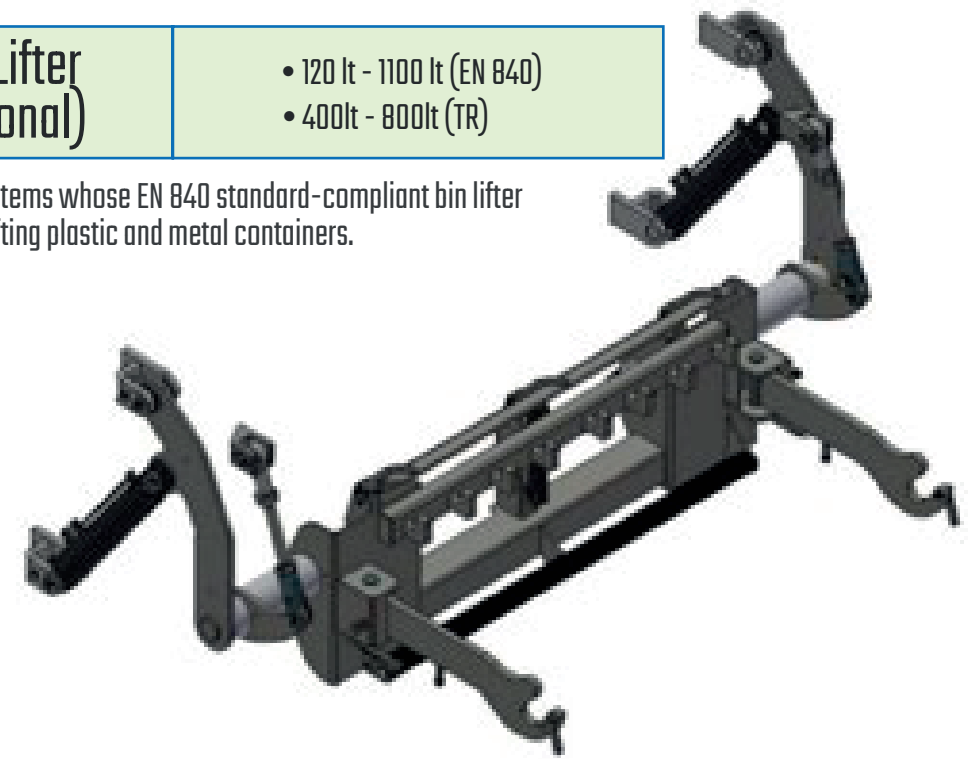

## 8. Optional Features

Hydraulic Control System	Manual Semi-automatic Automatic	Bin Stopper		Hopper Cover	
Bin Lid Opener		Steps (EN 1501)		Electrical Control System	<ul style="list-style-type: none"> <li>• PLC</li> <li>• ECU</li> <li>• ECU-CANBUS</li> </ul>
EN 1501: Refuse collection vehicles - General requirements and safety requirements		Ladder		Step Sensor	
Waste Water Tank		Fire Extinguisher Box		Inner Cabin Control	
Worker Safety Barriers EN 1501		Bicycle Stand EN 1501		Side Marker Lights	
Mud Guards		Manual Bin Washing System		Camera	
Bin Lifter		Tailgate Hopper		Body Lighting	
Hardox		Equipment Control Directions	Right / Left	Button Type	
		Vertical Cover			



## 9. Truck Warning Alarm System

Truck Warning Alarm System		
Manual	Semi-automatic	Automatic
Beacon Light	Beacon Light	Beacon Light
Hopper Lighting Lamps	Hopper Lighting Lamps	Hopper Lighting Lamps
Stop Lamps	Stop Lamps	Stop Lamps
Driver Warning	Driver Warning	Driver Warning
Side Marker Light (Optional)	Side Marker Light (Optional)	Reversing Buzzer
Safety Sensor Between Tailgate - Ejection Plate	Safety Sensor Between Tailgate - Ejection Plate	Side Marker Light (Optional)
		Step Sensor (Optional)
		30 km/h Speed Limiter Signal
		Camera System (Optional)
		Recovery Buttons
		Emergency Stop Buttons
		Safety Sensor Between Tailgate - Ejection Plate
		Two-Hand Control Button
		Full Container Sensor
		Tailgate Hopper Sensor



10. Compaction rate 1:6.

11. Tailgate can open up to 89°.

12. Following the analysis of each designed equipment via the programs, mass production of them is carried out after testing for at least 6 months in the field test.

13. The special design of the tailgate allowed it to be positioned very close to the truck cabin. In this way, high volume and carrying capacity are also provided in short chassis.

14. Through the installation of a closed-circuit camera system in the driver's cabin, the communication of the driver with the operators is increased and work safety is ensured. Ease of use is offered via an optional touch screen.

15. Equipment designs are made suitable for transportation in containers. In this way, our equipment is delivered to our customers all over the world.

16. Two-hand buttons are embedded in the body to provide a flat appearance. In this way, external deformations are prevented and convenience is ensured for the worker.

17. CKD-SKD and Disassembled production can be performed. Production can be made in line with business models depending on customer and market needs.

18. 1-year product warranty and 10-year spare parts supply warranty are provided.

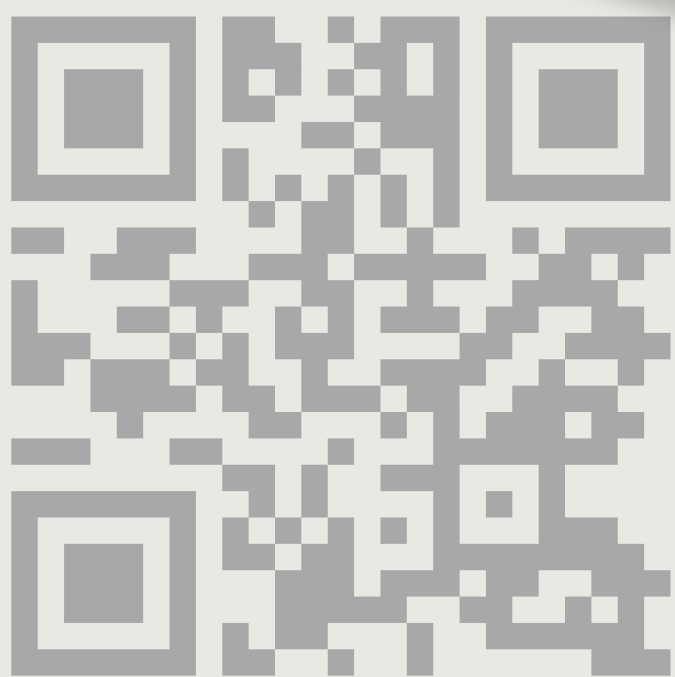

orakcimakina.com

Click to  Contact Us!