

ORV400

series

Hydraulic Refuse
Compactors



ORAKCI
Makina İmalat İth. İhr. San. ve Tic. A.Ş.



1. Equipment Dimensions

400 SERIES SQUARE CONTAINER EQUIPMENT DIMENSIONS																		
	Letter Code	12m³	13m³	14m³	15m³	16 m³	17m³	18m³	19m³	20m³	21m³	22m³	23m³	24m³	25m³	26m³	27m³	28m³
Rear Length	*C	2867																
Truck Ground Clearance	*CH	1000																
Total Length	D1	5612	5837	6062	6287	6512	6737	6962	7187	7412	7637	7862	8087	8312	8537	8762	8987	9212
Body Height	*E	3590																
Body Internal Height	H	2120																
Useful Chassis Length	*Ca	2774	2999	3224	3449	3674	3899	4124	4349	4574	4799	5024	5249	5474	5699	5924	6149	6374
Truck Chassis Width	CW	May Differ by Truck																
Body Length	G	3583	3808	4033	4258	4483	4708	4933	5158	5383	5608	5833	6058	6283	6508	6733	6958	7183
Hopper Length	K	1975																
Loading Height	*I	1000																
Hooper Height	*M	1430																
Body Internal Width	J1	2130																
Body External Width	J2	2316	2316	2316	2316	2316	2316	2316	2316	2316	2316	2316	2316	2316	2316	2316	2316	2316
Tailgate Hopper Internal Width	J3	1950																
Tailgate External Width	J4	2378	2378	2378	2378	2378	2378	2378	2378	2378	2378	2378	2378	2378	2378	2378	2378	2378
Chassis Back Length	P	900	900	900	900	900	900	900	900	900	900	900	900	900	900	900	900	900
Equipment Weight (kg) ±3%	*	5630	5765	5899	5992	6224	6293	6386	6566	6619	6824	6939	7033	7125	7221	7319	7448	7519

For equipment over 28 m³, you can contact your sales representative.

Parts marked with (*) may differ by truck. The final dimensions become clear after the draft work.

The table is for information purposes.

(*) These are the base equipment data, they do not include optional equipment or accessories.

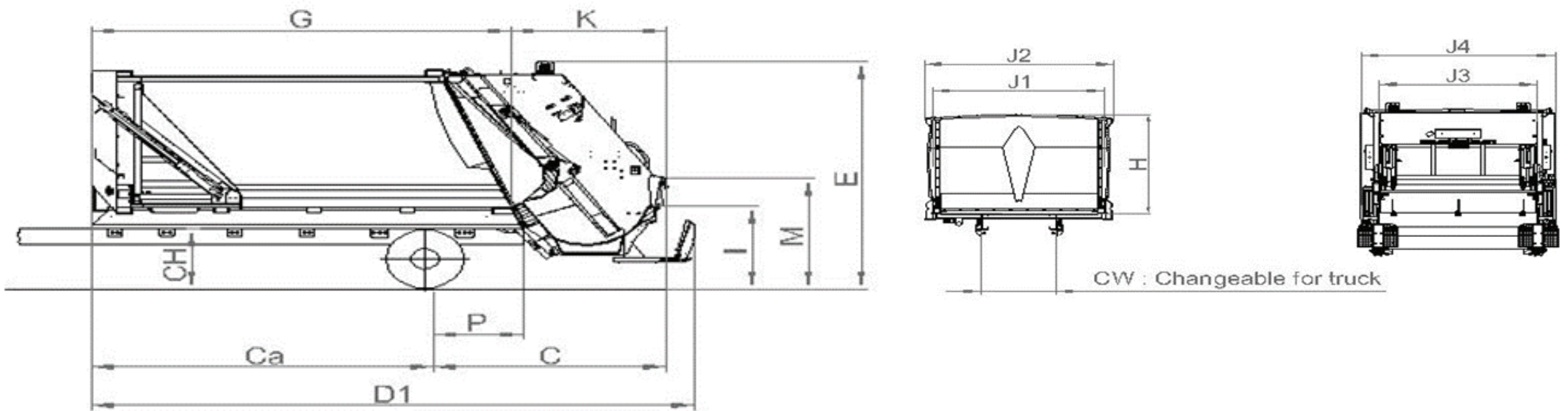

400 SERIES OVAL (CURVED) CONTAINER EQUIPMENT DIMENSIONS																		
	Letter Code	12m³	13m³	14m³	15m³	16 m³	17m³	18m³	19m³	20m³	21m³	22m³	23m³	24m³	25m³	26m³	27m³	28m³
Rear Length	*C	2867																
Truck Ground Clearance	*CH	1000																
Total Length	D1	5612	5837	6062	6287	6512	6737	6962	7187	7412	7637	7862	8087	8312	8537	8762	8987	9212
Body Height	*E	3590																
Body Internal Height	H	2154																
Useful Chassis Length	*Ca	2744	2969	3194	3419	3644	3869	4094	4319	4544	4769	4994	5219	5444	5669	5894	6119	6344
Truck Chassis Width	CW	May Differ by Truck																
Body Length	G	3538	3763	3988	4213	4438	4663	4888	5113	5338	5563	5788	6013	6238	6463	6688	6913	7138
Hopper Length	K	1975																
Loading Height	*I	1000																
Hooper Height	*M	1430																
Body Internal Width	J1	2130																
Body External Width	J2	2316	2316	2316	2316	2316	2316	2316	2316	2316	2316	2316	2316	2316	2316	2316	2316	2316
Tailgate Hopper Internal Width	J3	1950																
Tailgate External Width	J4	2378	2378	2378	2378	2378	2378	2378	2378	2378	2378	2378	2378	2378	2378	2378	2378	2378
Chassis Back Length	P	900	900	900	900	900	900	900	900	900	900	900	900	900	900	900	900	900
Equipment Weight (kg) ±3%	*	5543	5676	5808	5900	6050	6186	6277	6444	6506	6708	6821	6914	7004	7099	7195	7292	7392

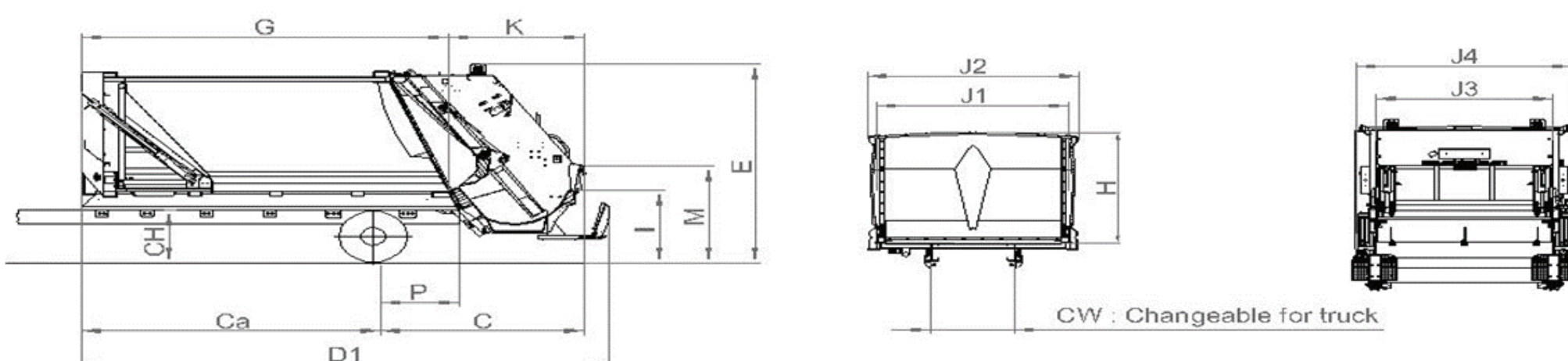

2. Body Capacity

Capacity	ORV 400
	12 m ³ - 28 m ³

Working Hours	Waste Loading Loop	Packaging Loop
	8-10 secs	14-22 secs



3. Tailgate

Capacity	-	400 Series
	Without Hopper Extension	1.5 m ³
	With Hopper Extension (Optional)	2 m ³

	Manual	Semi Automatic	Automatic
With Bin Lifter	Optional	Standard	Standard
Without Bin Lifter	Optional	Optional	Standard



4. Hydraulic Features

Pump	Pump Types	Gear Pump
		Vane Pump (Optional)
		Piston Pump (Optional)
		Tandem Pump (Optional)
Operating Pressure	180 bar	
Pump Flow Rate	400 Series	82 lt/min.
		* Pump values may differ depending on motor output speed. Motor output speed Max. 1000rpm
Oil Tank	Suction Filter	125 µc
	Return Filter	25 µc
	Capacity	160 - 200 lt



5. Materials Used

Material Features			
Material	Body Bottom	Body Top	Blade Bottom Sheet
	▪ S355J2C+N	▪ S355J2C+N	▪ Hardox 450
	Hardox 450 (Optional)	Hardox 450 (Optional)	
	Tailgate Hooper	Tailgate Side Wall	Slide Bottom Sheet
	▪ Hardox 450	▪ S355J2C+N Hardox 450 (Partial)	▪ S355J2C+N Hardox 450 (Optional)

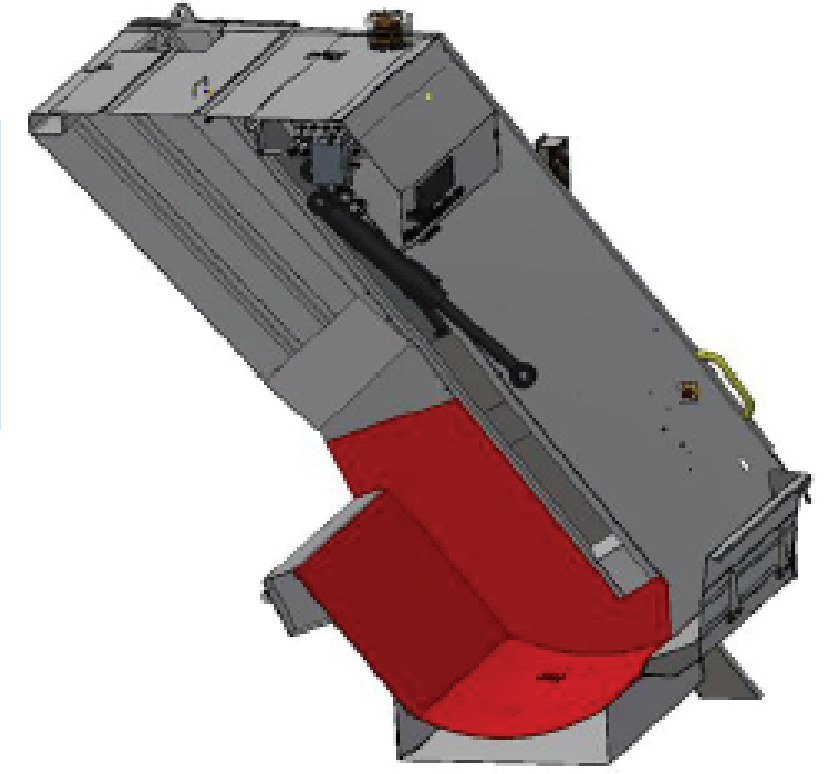

We offer Hardox 450 as an option for extending the useful life of the equipment located in the parts exposed to corrosion.

6. Bin Lifter Systems

Bin Lifter System	
Bin Lifter (Optional)	<ul style="list-style-type: none"> ▪ 120 lt - 1100 lt (EN 840) ▪ 120 lt - 1700 lt (EN 840) ▪ 400lt - 800lt (TR)
Skiploader System Bin Lifter (Optional)	▪ 3m ³ - 6m ³
Hydromotor Pulling Drum (Optional)	▪ 3m ³ - 6m ³

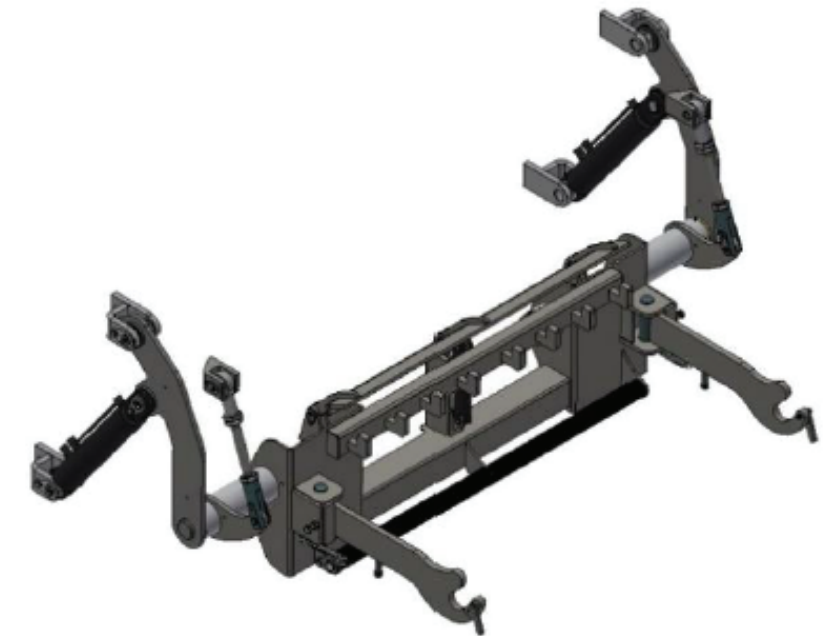

We produce systems whose EN 840 standard-compliant bin lifter is suitable for lifting plastic and metal containers.

7. Optional Features

Hydraulic Control System	<ul style="list-style-type: none"> ▪ Manual ▪ Semi-automatic ▪ Automatic 	Hardox	HARDOX® WEAR PLATE	Tailgate Hopper		Electrical Control System	<ul style="list-style-type: none"> • PLC • ECU • ECU-CANBUS
Bin Lid Opener		Bin Stopper		Equipment Control Directions	Right / Left	Step Sensor	
EN 1501 : Refuse collection vehicles -General requirements and safety requirements		Steps (EN 1501)		Vertical Cover		Inner Cabin Control	
Wastewater Tank		Ladder		Vertical Tank Cover		Side Marker Lights	
Worker Safety Barriers EN 1501		Fire Extinguisher Box		Skiploader System		Camera	
Mud Guards		Bicycle Stand EN 1501		Hydromotor Pulling Drum		Container Body Lighting	
Bin Lifter		Manual Bin Washing System		Audio Alarm System		Button Type	

Please contact ORAKCI MAKİNA for optional requests.

8. Truck Warning Alarm System

Truck Warning Alarm System		
Manual	Semi automatic	Automatic
Beacon Light	Beacon Light	Beacon Light
Hopper Lighting Lamps	Hopper Lighting Lamps	Hopper Lighting Lamps
Stop Lamps	Stop Lamps	Stop Lamps
Driver Warning	Driver Warning	Driver Warning
Side Marker Light (Optional)	Side Marker Light (Optional)	Side Marker Light (Optional)
Safety Sensor Between Tailgate Ejection Plate	Safety Sensor Between Tailgate Ejection Plate	Reversing Buzzer
		Step Sensor (Optional)
		30 km/h Speed Limiter Signal
		Camera System (Optional)
		Inner Tank Recovery Buttons
		Outer Tank Stop Buttons
		Safety Sensor Between Tailgate Ejection Plate
		Two Hand Control Button
		Full Body Sensor (Optional)
		Tailgate Hopper Sensor

9.Compaction rate 1:6.

10.Tailgate can open up to 89°.

11.The curved top allows the equipment to have no water discharge problem in areas with heavy precipitation.

12.Following the analysis of each designed equipment via the programs, mass production of them is carried out after testing for at least 6 months in the field test.

13.The special design of the tailgate allowed it to be positioned very close to the truck cabin. In this way, high volume and carrying capacity are also provided in short chassis.

14.Through the installation of a closed-circuit camera system in the driver's cabin, the communication of the driver with the operators is increased and work safety is ensured.

Ease of use is offered via an optional touch screen.

15.Equipment designs are made suitable for transportation in containers.

In this way, our equipment is delivered to our customers all over the world.

Tax exemption is provided to our customers through disassembled equipment.

16.CKD-SKD and Disassembled production can be performed.

Production can be made in line with business models depending on customer and market needs.

17.Two-hand buttons are embedded in the body to provide a flat appearance.

In this way, external deformations are prevented and convenience is ensured for the worker.

18.1-year product warranty and 10-year spare parts supply warranty is provided.

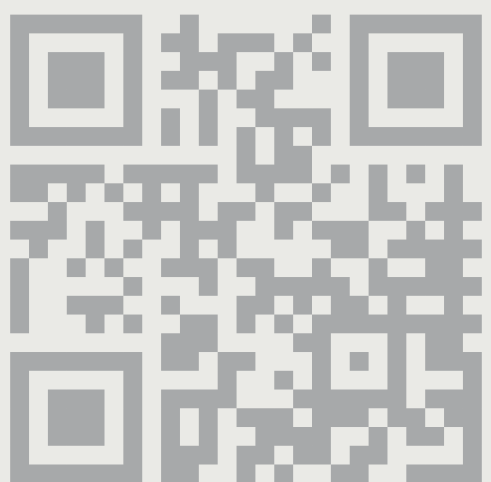

orakcimakina.com

Click for
Contact Us!

