

# ORC

## series

Refuse Vehicle  
With Crane



# 1. Equipment Dimensions

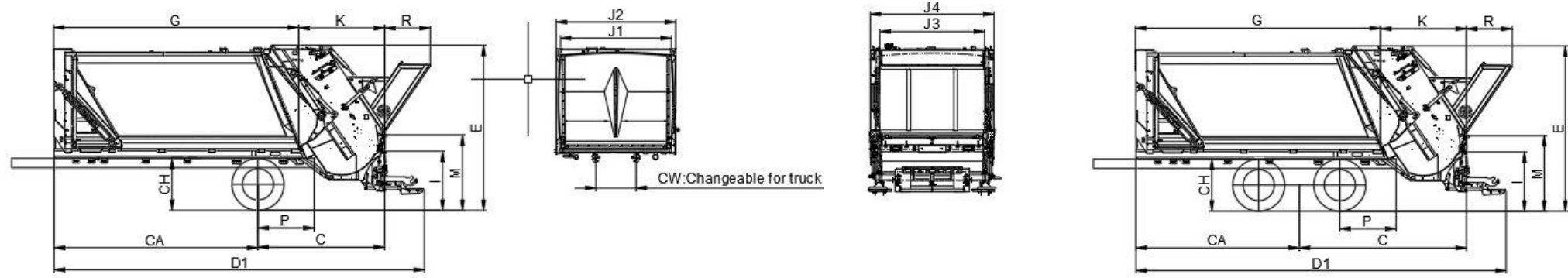

	Letter Code	10m <sup>3</sup>	11m <sup>3</sup>	12m <sup>3</sup>	13m <sup>3</sup>	14m <sup>3</sup>	15m <sup>3</sup>	16m <sup>3</sup>
Rear Overhang	*C	2457						
Truck Ground Clearance	*CH	1000						
Total Length	D1	5372	5627	5882	6137	6392	6647	6902
Body Height	*E	3263						
Body Internal Height	H	1850						
Useful Chassis Length	*Ca	2639	2894	3149	3404	3659	3914	4169
Truck Chassis Width	CW	May Differ by Truck						
Body Length	G	3455	3710	3965	4220	4475	4730	4985
Hopper Length	K	1665						
Loading Height	*I	1115						
Hopper Height	*M	1480						
Body Internal Width	J1	2130						
Body External Width	J2	2316						
Tailgate Hopper Internal Width	J3	1950						
Tailgate External Width	J4	2378						
Chassis Back Length	P	900						
Equipment Weight (kg) ±3%	*	Weight may differ by equipment.						
Funnel Length	R	It may vary according to needs.						

Parts marked with (\*) may differ by truck. The final dimensions become clear after the draft work. The table is for information purposes.

(\*) These are the base equipment data, they do not include optional equipment or accessories.

The equipment dimensions may vary by ±3% depending on the general tolerances.

The dimensions may vary depending on the optional features of the equipment (funnel, etc.).

	Letter Code	13m <sup>3</sup>	14m <sup>3</sup>	15m <sup>3</sup>	16m <sup>3</sup>	17m <sup>3</sup>	18m <sup>3</sup>	19m <sup>3</sup>	20m <sup>3</sup>	21m <sup>3</sup>	22m <sup>3</sup>	23m <sup>3</sup>	24m <sup>3</sup>	25m <sup>3</sup>	26m <sup>3</sup>	27m <sup>3</sup>	28m <sup>3</sup>
Rear Length	*C	2867															
Truck Ground Clearance	*CH	1000															
Total Length	D1	5837	6062	6287	6512	6737	6962	7187	7412	7637	7862	8087	8312	8537	8762	8987	9212
Body Height	*E	3590															
Body Internal Height	H	2120															
Useful Chassis Length	*Ca	2999	3224	3449	3674	3899	4124	4349	4574	4799	5024	5249	5474	5699	5924	6149	6374
Truck Chassis Width	CW	May Differ by Truck															
Body Length	G	3821	4046	4271	4496	4721	4946	5171	5396	5621	5846	6071	6296	6521	6746	6971	7196
Hopper Length	K	1975															
Loading Height	*I	1000															
Body Height	*M	1430															
Body Internal Width	J1	2130															
Body External Width	J2	2316	2316	2316	2316	2316	2316	2316	2316	2316	2316	2316	2316	2316	2316	2316	2316
Tailgate Hopper Internal Width	J3	1950															
Tailgate External Width	J4	2378	2378	2378	2378	2378	2378	2378	2378	2378	2378	2378	2378	2378	2378	2378	2378
Chassis Back Length	P							900									
Equipment Weight (kg) ±3%	*	Weight may differ by equipment.															
Funnel Length	R	It may vary according to needs.															

For equipment over 28 m<sup>3</sup>, you can contact your sales representative.

Parts marked with (\*) may differ by truck. The final dimensions become clear after the draft work.

The table is for information purposes.

(\*) These are the base equipment data, they do not include optional equipment or accessories.

The equipment dimensions may vary by ±3% depending on the general tolerances.

The dimensions may vary depending on the optional features of the equipment (funnel, etc.).

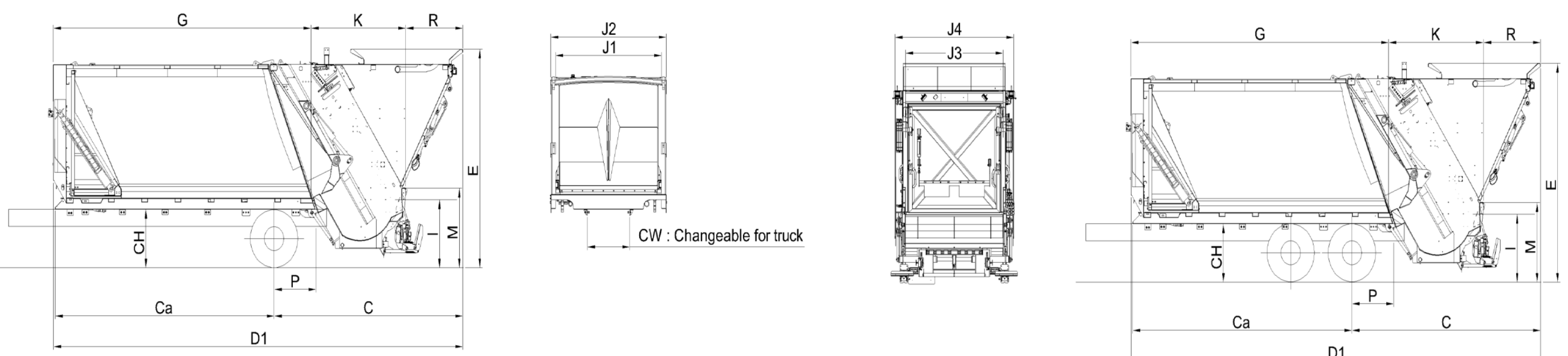



## 2. Container Capacity

<b>Capacity</b>	10 m <sup>3</sup> - 16 m <sup>3</sup>	13 m <sup>3</sup> - 28 m <sup>3</sup>
-----------------	---------------------------------------	---------------------------------------



## 3. Tailgate

<b>Volume</b>	1.5 m <sup>3</sup>	2 m <sup>3</sup>
---------------	--------------------	------------------



## 4. Waste Water Tank Capacity

Body		Tailgate	
ORC 3 SERIES		ORC 3 SERIES	
Tank	50 lt	Tank (Optional)	180 lt
Additional Tank (Optional)	180 lt		

Body		Tailgate	
ORC 4 SERIES		ORC 4 SERIES	
Tank	60 lt	Tank (Optional)	190 lt
Additional Tank (Optional)	180 lt		

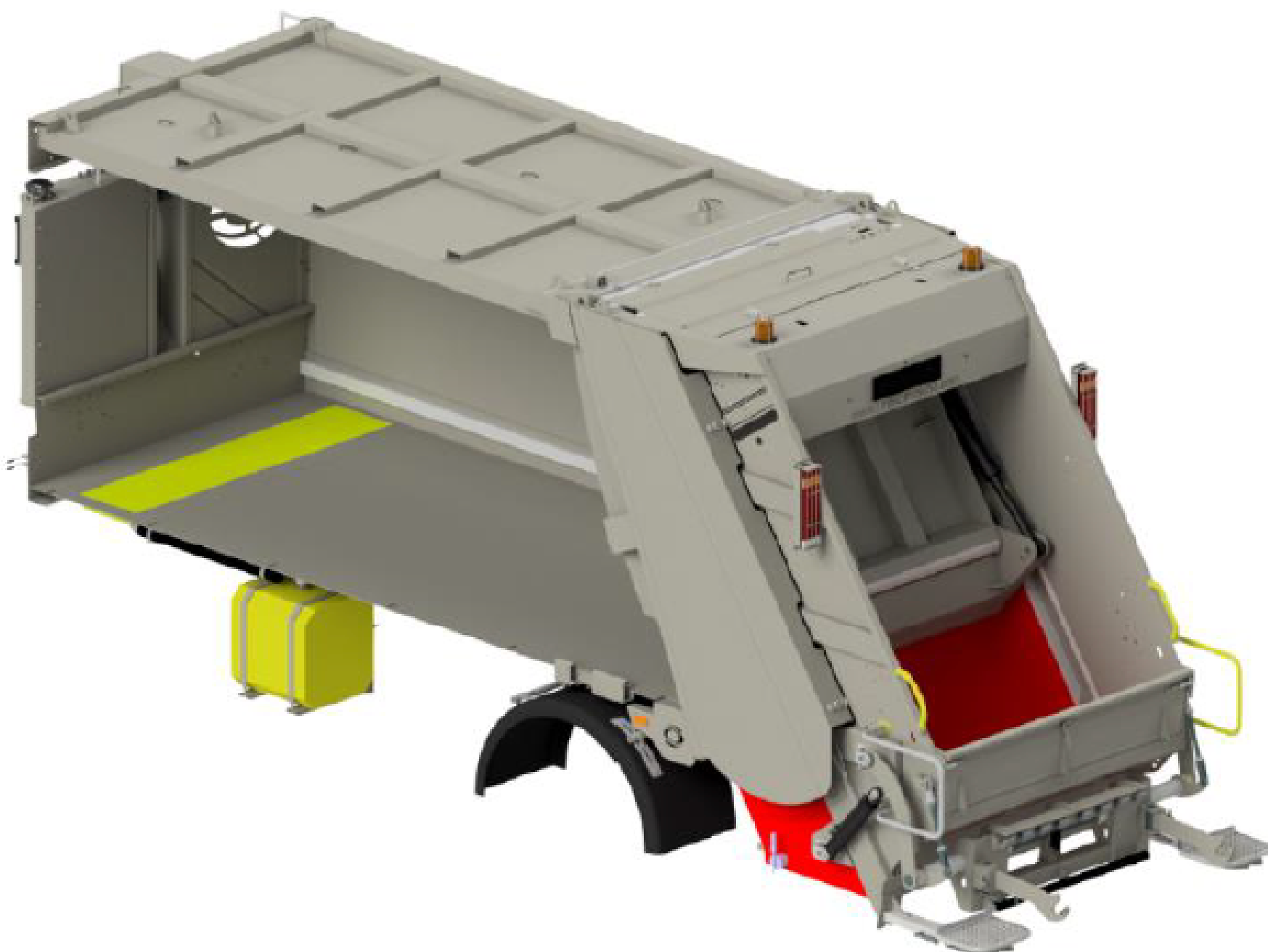

## 5. Hydraulic Features

<b>Pump</b>	<b>Pump Types</b>	Gear Pump
		Piston Pump (Optional)
		Vane Pump (Optional)
		Tandem Pump (Optional)
	<b>Operating Pressure</b>	180 Bar
<b>Pump Flow Rate</b>	82 lt/min.	
	* Pump values may differ depending on motor output speed. Motor output speed Max. 1000rpm	
<b>Oil Tank</b>	<b>Capacity</b>	160-200 lt
	<b>Suction Filter</b>	125 µc
	<b>Return Filter</b>	



## 6. Materials Used

<b>Material</b>	<b>Body Bottom</b>	<b>Body Top</b>	<b>Blade Bottom Sheet</b>	
	S355J2C+N	S355J2C+N	Hardox 450	
	Hardox 450 (Optional)	Hardox 450 (Optional)		
	<b>Tailgate Hopper</b>	<b>Tailgate Side Wall</b>	<b>Slide Bottom Sheet</b>	
	Hardox 450	S355J2C+N		S355J2C+N
Hardox 450 (Optional)		Hardox 450 (Optional)		

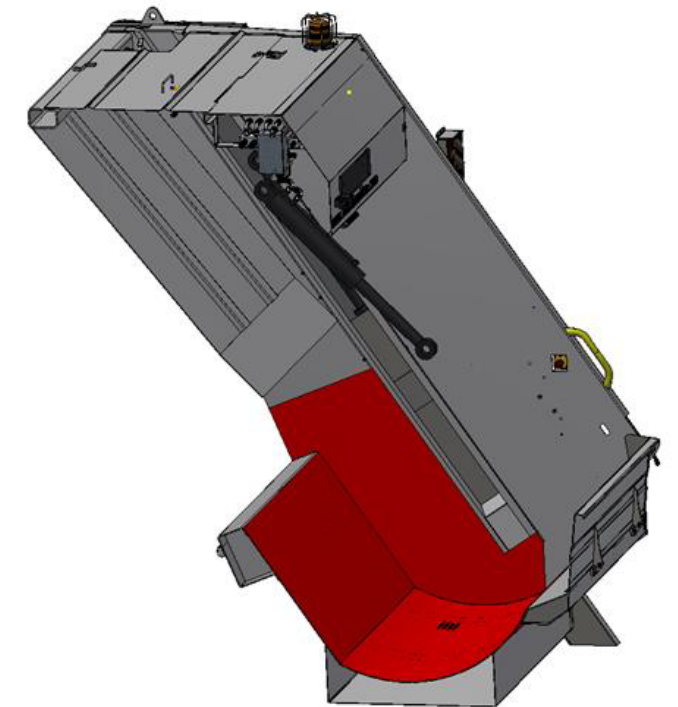

**HARDOX**<sup>®</sup>  
WEAR PLATE

We offer Hardox 450 as an option for extending the useful life of the equipment located in the parts exposed to corrosion.

## 7. Bin Lifter Systems

<b>Bin Lifter (Optional)</b>	120 lt - 1100 lt (EN 840) 400lt - 800lt (TR)
------------------------------	---

We produce systems whose EN 840 standard-compliant bin lifter is suitable for lifting plastic and metal containers.

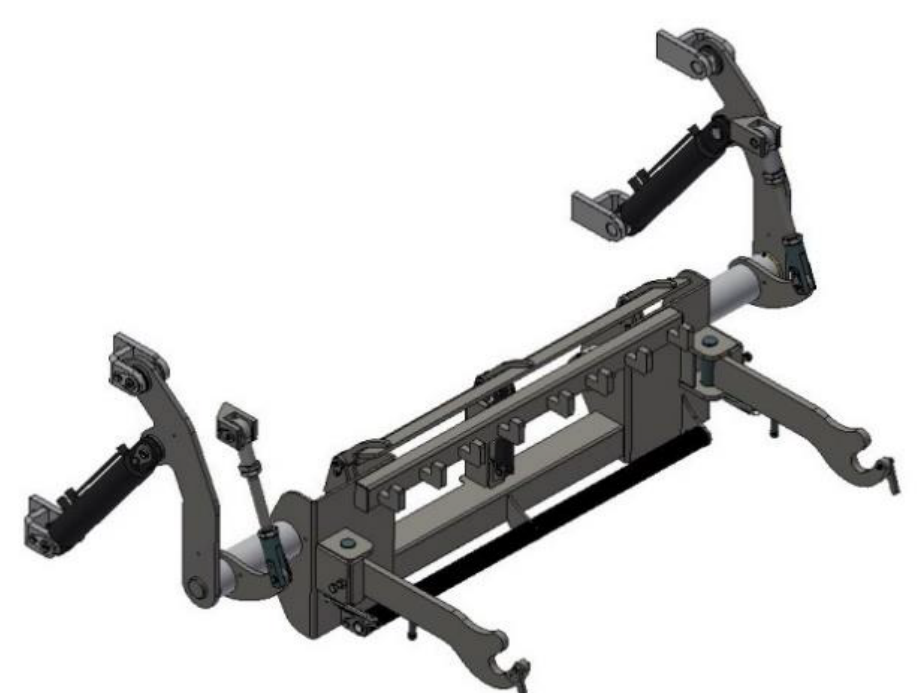



## 8. Optional Features

Hydraulic Control System	Manual Semi-automatic Automatic	Hardox	<b>HARDOX®</b> WEAR PLATE	Electrical Control System	PLC ECU ECU-CANBUS
Bin Lid Opener		Bin Stopper		Step Sensor	
EN 1501		Steps (EN 1501)		Inner Cabin Control	
Wastewater Tank		Ladder		Side Marker Lights	
Worker Safety Barriers EN 1501		Fire Extinguisher Box		Camera	
Mud Guards		Bicycle Stand EN 1501		Body Lighting	
Bin Lifter		Manual Bin Washing System		Button Type	

## 9. Truck Warning Alarm System

Manual	Semi-automatic	Automatic
Beacon Light	Beacon Light	Beacon Light
Hopper Lighting Lamps	Hopper Lighting Lamps	Hopper Lighting Lamps
Stop Lamps	Stop Lamps	Stop Lamps
Driver Warning	Driver Warning	Driver Warning
Side Marker Light (Optional)	Side Marker Light (Optional)	Side Marker Light (Optional)
Safety Sensor Between Tailgate Ejection Plate	Safety Sensor Between Tailgate Ejection Plate	Reversing Buzzer
		Step Sensor (Optional)
		30 km/h Speed Limiter Signal
		Camera System (Optional)
		Inner Tank Recovery Buttons
		Outer Tank Stop Buttons
		Safety Sensor Between Tailgate Ejection Plate
		Two Hand Control Button
		Full Body Sensor (Optional)
		Tailgate Hopper Sensor

10.Compaction rate 1:6.

11.Tailgate can open up to 89°.

12.Two-hand buttons are embedded in the body to provide a flat appearance. In this way, external deformations are prevented and convenience is ensured for the worker.

13.Following the analysis of each designed equipment via the programs, mass production of them is carried out after testing for at least 6 months in the field test.

14.The special design of the tailgate allowed it to be positioned very close to the truck cabin. In this way, high volume and carrying capacity are also provided in short chassis.

15.Through the installation of a closed-circuit camera system in the driver's cabin, the communication of the driver with the operators is increased and work safety is ensured. Ease of use is offered via an optional touch screen.

16.Equipment designs are made suitable for transportation in containers. In this way, our equipment is delivered to our customers all over the world.

17.CKD-SKD and Disassembled production can be performed. Production can be made in line with business models depending on customer and market needs.

18.Spare parts service is offered after the warranty. 1-year product warranty and 10-year spare parts supply guarantee.

